

Coaxial Adapters

DC～110GHz 同軸アダプタ
セレクションガイド



RF ONEが供給する、SMA, SSMP, SMP, BNC, Type-N, TNCA, 3.5mm, 2.92mm(Kタイプ), 2.4mm, 1.85mm(Vタイプ), 1.0mmコネクタの中継および変換アダプタはフランジタイプ、バルクヘッドタイプ、直角およびストレートスタイル。これらのアダプタは、汎用または精密な測定で広く使用できます。

プレジジョン（Pモデル）、低価格汎用（Bモデル）、優れたPIM<-160dBc（Lモデル）。

ほとんどの製品がメーカー在庫のため短納期。

プレジジョンタイプ(同種コネクタ)
Pモデル

Pタイプアダプタは、VSWRと挿入損失が非常に低く、再現性のあるパフォーマンスと頑丈な構造による高い耐久性を備えています。

モデル番号	周波数 (GHz)	コネクタ 1	コネクタ 2	スタイル	VSWR
A11001P	110	1.0mm Female	1.0mm Female	Straight	1.35
A11002P	110	1.0mm Female	1.0mm Male	Straight	1.35
A11003P	110	1.0mm Male	1.0mm Male	Straight	1.35
A6501P	67	1.85mm Female	1.85mm Female	Straight	1.25
A6501P-Y1	67	1.85mm Female	1.85mm Female	Bulkhead	1.25
A6502P	67	1.85mm Female	1.85mm Male	Straight	1.25
A6503P	67	1.85mm Male	1.85mm Male	Straight	1.25
A5001P	50	2.4mm Female	2.4mm Female	Straight	1.2
A5001P-F1	50	2.4mm Female	2.4mm Female	4 Hole Flange	1.2
A5001P-Y1	50	2.4mm Female	2.4mm Female	Bulkhead	1.2
A5002P	50	2.4mm Female	2.4mm Male	Straight	1.2
A5003P	50	2.4mm Male	2.4mm Male	Straight	1.2
A4001P	40	2.92mm Male	2.92mm Female	Straight	1.15
A4001P-F1	40	2.92mm Male	2.92mm Female	4 Hole Flange	1.2
A4001P-Y1	40	2.92mm Male	2.92mm Female	Bulkhead	1.15
A4001P-RA1	40	2.92mm Female	2.92mm Male	Right Angle	1.25
A4002P	40	2.92mm Female	2.92mm Female	Straight	1.2
A4002P-F1	40	2.92mm Female	2.92mm Female	4 Hole Flange	1.2
A4002P-Y1	40	2.92mm Female	2.92mm Female	Bulkhead	1.2
A4002P-RA1	40	2.92mm Female	2.92mm Female	Right Angle	1.25
A4003P	40	2.92mm Male	2.92mm Male	Straight	1.15
A4003P-RA1	40	2.92mm Male	2.92mm Male	Right Angle	1.25
A3301P	33	3.5mm Female	3.5mm Female	Straight	1.15
A3301P-F1	33	3.5mm Female	3.5mm Female	4 Hole Flange	1.15
A3301P-Y1	33	3.5mm Female	3.5mm Female	Bulkhead	1.15
A3301P-RA1	33	3.5mm Female	3.5mm Female	Right Angle	1.25
A3302P	33	3.5mm Female	3.5mm Male	Straight	1.15
A3302P-RA1	33	3.5mm Female	3.5mm Male	Right Angle	1.25
A3303P	33	3.5mm Male	3.5mm Male	Straight	1.15
A3303P-RA1	33	3.5mm Male	3.5mm Male	Right Angle	1.25

コネクタスタイル

Straight



A11001P

Bulkhead



A6501P-Y1

4 Hole Flange



A5001P-F1

Right Angle



プレジジョンタイプ(同種コネクタ)
Pモデル

モデル番号	周波数 (GHz)	コネクタ 1	コネクタ 2	スタイル	VSWR
A2701P	27	SMA Female	SMA Female	Straight	1.15
A2701P-F1	27	SMA Female	SMA Female	4 Hole Flange	1.15
A2701P-Y1	27	SMA Female	SMA Female	Bulkhead	1.15
A2701P-RA1	27	SMA Female	SMA Female	Right Angle	1.25
A2702P	27	SMA Male	SMA Female	Straight	1.15
A2702P-F	27	SMA Male	SMA Female	4 Hole Flange	1.15
A2702P-RA1	27	SMA Male	SMA Female	Right Angle	1.25
A2703P	27	SMA Male	SMA Male	Straight	1.15
A2703P-RA1	27	SMA Male	SMA Male	Right Angle	1.25

プレジジョンタイプ(アダプタ)
Pモデル

モデル番号	周波数 (GHz)	コネクタ 1	コネクタ 2	スタイル	VSWR
A6504P	67	1.85mm Female	1.0mm Female	Straight	1.25
A6505P	67	1.85mm Female	1.0mm Male	Straight	1.25
A6506P	67	1.85mm Male	1.0mm Female	Straight	1.25
A6507P	67	1.85mm Male	1.0mm Male	Straight	1.25
A5004P	50	2.4mm Female	1.85mm Female	Straight	1.25
A5005P	50	2.4mm Male	1.85mm Female	Straight	1.25
A5006P	50	2.4mm Female	1.85mm Male	Straight	1.25
A5007P	50	2.4mm Male	1.85mm Male	Straight	1.25
A4007P	40	2.92mm Female	2.4mm Female	Straight	1.2
A4007P-F1	40	2.92mm Female	2.4mm Female	4 Hole Flange	1.2
A4008P	40	2.92mm Male	2.4mm Female	Straight	1.15
A4009P	40	2.92mm Female	2.4mm Male	Straight	1.15
A4010P	40	2.92mm Male	2.4mm Male	Straight	1.15
A4011P	40	2.92mm Female	1.85mm Female	Straight	1.2
A4012P	40	2.92mm Male	1.85mm Female	Straight	1.15
A4013P	40	2.92mm Female	1.85mm Male	Straight	1.15
A4014P	40	2.92mm Male	1.85mm Male	Straight	1.15
A3304P	33	3.5mm Female	2.92mm Female	Straight	1.15
A3305P	33	3.5mm Male	2.92mm Female	Straight	1.15
A3306P	33	3.5mm Female	2.92mm Male	Straight	1.15
A3307P	33	3.5mm Male	2.92mm Male	Straight	1.15
A3308P	33	3.5mm Female	2.4mm Female	Straight	1.15
A3309P	33	3.5mm Male	2.4mm Female	Straight	1.15
A3310P	33	3.5mm Female	2.4mm Male	Straight	1.15
A3311P	33	3.5mm Male	2.4mm Male	Straight	1.15
A3312P	33	3.5mm Female	1.85mm Female	Straight	1.15
A3313P	33	3.5mm Male	1.85mm Female	Straight	1.15
A3314P	33	3.5mm Female	1.85mm Male	Straight	1.15
A3315P	33	3.5mm Male	1.85mm Male	Straight	1.15
A2709P	27	SMA Female	3.5mm Female	Straight	1.15
A2710P	27	SMA Female	3.5mm Male	Straight	1.15
A2711P	27	SMA Male	3.5mm Female	Straight	1.15
A2712P	27	SMA Male	3.5mm Male	Straight	1.15
A2713P	27	SMA Female	2.92mm Female	Straight	1.15
A2714P	27	SMA Female	2.92mm Male	Straight	1.15
A2715P	27	SMA Male	2.92mm Female	Straight	1.15

優れたVSWRと挿入損失 DC～33GHz, 27GHz, 18GHz

モデル番号	周波数 (GHz)	コネクタ 1	コネクタ 2	スタイル	VSWR
A1801P	18	N Male	N Female	Straight	1.15
A1809P	18	N Female	N Female	Straight	1.15
A1809P-F1	18	N Female	N Female	4 Hole Flange	1.15
A1809P-Y1	18	N Female	N Female	Bulkhead	1.15
A1810P	18	N Male	N Male	Straight	1.15
A1806P	18	TNCA Female	TNCA Female	Straight	1.25
A1806P-F1	18	TNCA Female	TNCA Female	4 Hole Flange	1.25
A1806P-Y1	18	TNCA Female	TNCA Female	Bulkhead	1.25
A1807P	18	TNCA Female	TNCA Male	Straight	1.25
A1808P	18	TNCA Male	TNCA Male	Straight	1.25



3.5mm J to J



SMA P to P



N P to J

モデル番号	周波数 (GHz)	コネクタ 1	コネクタ 2	スタイル	VSWR
A2716P	27	SMA Male	2.92mm Male	Straight	1.15
A2717P	27	SMA Female	2.4mm Female	Straight	1.15
A2718P	27	SMA Female	2.4mm Male	Straight	1.15
A2719P	27	SMA Male	2.4mm Female	Straight	1.15
A2720P	27	SMA Male	2.4mm Male	Straight	1.15
A1802P	18	N Female	SMA Female	Straight	1.15
A1802P-F1	18	N Female	SMA Female	4 Hole Flange	1.15
A1802P-Y1	18	N Female	SMA Female	Bulkhead	1.15
A1803P	18	N Female	SMA Male	Straight	1.15
A1804P	18	N Male	SMA Male	Straight	1.15
A1805P	18	N Male	SMA Female	Straight	1.15
A1811P	18	N Female	3.5mm Female	Straight	1.15
A1812P	18	N Male	3.5mm Female	Straight	1.15
A1813P	18	N Female	3.5mm Male	Straight	1.15
A1814P	18	N Male	3.5mm Male	Straight	1.15
A1815P	18	N Female	2.92mm Female	Straight	1.15
A1816P	18	N Male	2.92mm Female	Straight	1.15
A1817P	18	N Female	2.92mm Male	Straight	1.15
A1818P	18	N Male	2.92mm Male	Straight	1.15
A1819P	18	N Female	2.4mm Female	Straight	1.15
A1820P	18	N Male	2.4mm Female	Straight	1.15
A1821P	18	N Female	2.4mm Male	Straight	1.15
A1822P	18	N Male	2.4mm Male	Straight	1.15
A1823P	18	N Female	TNCA Female	Straight	1.25
A1824P	18	N Female	TNCA Male	Straight	1.25
A1825P	18	N Male	TNCA Female	Straight	1.25
A1826P	18	N Male	TNCA Male	Straight	1.25
A1827P	18	TNCA Female	SMA Female	Straight	1.25
A1827P-F1	18	TNCA Female	SMA Female	4 Hole Flange	1.25
A1828P	18	TNCA Male	SMA Female	Straight	1.25
A1829P	18	TNCA Female	SMA Male	Straight	1.25
A1830P	18	TNCA Male	SMA Male	Straight	1.25

汎用タイプ(同種コネクタ)
Bモデル

モデル番号	周波数 (GHz)	コネクタ 1	コネクタ 2	スタイル	VSWR
A6701B	67	1.85mm Female	1.85mm Female	Straight	1.3
A6702B	67	1.85mm Male	1.85mm Male	Straight	1.3
A6703B	67	1.85mm Female	1.85mm Male	Straight	1.3
A6701B-RA	50	1.85mm Female	1.85mm Female	Right Angle	1.35
A6702B-RA	50	1.85mm Male	1.85mm Male	Right Angle	1.35
A6703B-RA	50	1.85mm Female	1.85mm Male	Right Angle	1.35
A5001B	50	2.4mm Female	2.4mm Female	Straight	1.2
A5001B-F1	50	2.4mm Female	2.4mm Female	4 Hole Flange	1.2
A5001B-RA	50	2.4mm Female	2.4mm Female	Right Angle	1.35

- ・～67GHz, N type, SMA, SSMA, SMP, SSMP, 3.5mm, 2.92mm, 2.4mm, 1.85mm
- ・指にやさしい機械設計, 優れたVSWR, ・ベンチテスト向けに最適
- ・ステンレススチール製 ・100% RF テスト, メーカー在庫

モデル番号	周波数 (GHz)	コネクタ 1	コネクタ 2	スタイル	VSWR
A5002B	50	2.4mm Male	2.4mm Male	Straight	1.2
A5002B-RA	50	2.4mm Male	2.4mm Male	Right Angle	1.35
A5003B	50	2.4mm Female	2.4mm Male	Straight	1.2
A5003B-RA	50	2.4mm Female	2.4mm Male	Right Angle	1.35
A4001B	40	2.92mm Female	2.92mm Female	Straight	1.2
A4001B-F1	40	2.92mm Female	2.92mm Female	4 Hole Flange	1.2
A4001B-Y1	40	2.92mm Female	2.92mm Female	Bulkhead	1.2
A4001B-RA	40	2.92mm Female	2.92mm Female	Right Angle	1.25
A4002B	40	2.92mm Male	2.92mm Male	Straight	1.2

汎用タイプ(同種コネクタ) Bモデル

モデル番号	周波数 (GHz)	コネクタ 1	コネクタ 2	スタイル	VSWR
A4002B-RA	40	2.92mm Male	2.92mm Male	Right Angle	1.25
A4003B	40	2.92mm Female	2.92mm Male	Straight	1.2
A4003B-RA	40	2.92mm Female	2.92mm Male	Right Angle	1.25
A4032B	40	SSMA Female	SSMA Female	Straight	1.2
A4033B	40	SSMA Male	SSMA Male	Straight	1.2
A4034B	40	SSMA Male	SSMA Female	Straight	1.2
A2701B	34	3.5mm Female	3.5mm Female	Straight	1.2
A2701B-F1	34	3.5mm Female	3.5mm Female	4 Hole Flange	1.2

汎用タイプ(アダプタ) Bモデル

モデル番号	周波数 (GHz)	コネクタ 1	コネクタ 2	スタイル	VSWR
A5004B	50	2.4mm Male	1.85mm Male	Straight	1.2
A5004B-RA	50	2.4mm Male	1.85mm Male	Right Angle	1.35
A5005B	50	2.4mm Male	1.85mm Female	Straight	1.2
A5005B-RA	50	2.4mm Male	1.85mm Female	Right Angle	1.35
A5006B	50	2.4mm Female	1.85mm Male	Straight	1.2
A5006B-RA	50	2.4mm Female	1.85mm Male	Right Angle	1.35
A5007B	50	2.4mm Female	1.85mm Female	Straight	1.2
A5007B-RA	50	2.4mm Female	1.85mm Female	Right Angle	1.35
A4004B	40	2.92mm Female	2.4mm Female	Straight	1.2
A4004B-RA	40	2.92mm Female	2.4mm Female	Right Angle	1.25
A4005B	40	2.92mm Female	2.4mm Male	Straight	1.2
A4005B-RA	40	2.92mm Female	2.4mm Male	Right Angle	1.25
A4006B	40	2.92mm Male	2.4mm Male	Straight	1.2
A4006B-RA	40	2.92mm Male	2.4mm Male	Right Angle	1.25
A4007B	40	2.92mm Male	2.4mm Female	Straight	1.2
A4007B-RA	40	2.92mm Male	2.4mm Female	Right Angle	1.25
A4008B	40	2.92mm Male	1.85mm Male	Straight	1.2
A4008B-RA	40	2.92mm Male	1.85mm Male	Right Angle	1.25
A4009B	40	2.92mm Male	1.85mm Female	Straight	1.2
A4009B-RA	40	2.92mm Male	1.85mm Female	Right Angle	1.25
A4010B	40	2.92mm Female	1.85mm Female	Straight	1.2
A4010B-RA	40	2.92mm Female	1.85mm Female	Right Angle	1.25
A4011B	40	2.92mm Female	1.85mm Male	Straight	1.2
A4011B-RA	40	2.92mm Female	1.85mm Male	Right Angle	1.25
A4011B	40	2.92mm Female	1.85mm Male	Straight	1.2
A4011B-RA	40	2.92mm Female	1.85mm Male	Right Angle	1.25
A4012B	40	2.92mm Male	SMP Male	Straight	1.3
A4013B	40	2.92mm Male	SMP Female	Straight	1.3
A4014B	40	2.92mm Female	SMP Male	Straight	1.3
A4015B	40	2.92mm Female	SMP Female	Straight	1.3
A4016B	40	2.4mm Male	SMP Male	Straight	1.3
A4017B	40	2.4mm Male	SMP Female	Straight	1.3
A4018B	40	2.4mm Female	SMP Male	Straight	1.3
A4019B	40	2.4mm Female	SMP Female	Straight	1.3
A4020B	40	2.92mm Male	SSMA Male	Straight	1.2
A4021B	40	2.92mm Male	SSMA Female	Straight	1.2
A4022B	40	2.92mm Female	SSMA Male	Straight	1.2
A4023B	40	2.92mm Female	SSMA Female	Straight	1.2
A4024B	40	2.92mm Male	SSMP Male	Straight	1.3
A4025B	40	2.92mm Male	SSMP Female	Straight	1.3
A4026B	40	2.92mm Female	SSMP Male	Straight	1.3
A4027B	40	2.92mm Female	SSMP Female	Straight	1.3
A4028B	40	2.4mm Male	SSMP Male	Straight	1.3
A4029B	40	2.4mm Male	SSMP Female	Straight	1.3
A4030B	40	2.4mm Female	SSMP Male	Straight	1.3
A4031B	40	2.4mm Female	SSMP Female	Straight	1.3
A4035B	40	SSMA Male	SMP Male	Straight	1.3
A4036B	40	SSMA Male	SMP Female	Straight	1.3
A4037B	40	SSMA Female	SMP Male	Straight	1.3

- ・コストパフォーマンス・ステンレススチール製
- ・100% RF テスト, メーカー在庫

モデル番号	周波数 (GHz)	コネクタ 1	コネクタ 2	スタイル	VSWR
A2702B	34	3.5mm Male	3.5mm Male	Straight	1.2
A2703B	34	3.5mm Female	3.5mm Male	Straight	1.2
A1825B	18	N Female	N Female	Straight	1.15
A1826B	18	N Female	N Male	Straight	1.15
A1827B	18	N Male	N Male	Straight	1.15
A1828B	18	SMA Female	SMA Female	Straight	1.15
A1829B	18	SMA Male	SMA Male	Straight	1.15
A1830B	18	SMA Male	SMA Female	Straight	1.15

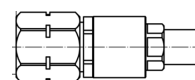

2.4mm P to SSMP P

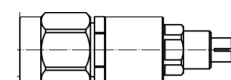

2.92mm P to SMP J

モデル番号	周波数 (GHz)	コネクタ 1	コネクタ 2	スタイル	VSWR
A4038B	40	SSMA Female	SMP Female	Straight	1.3
A4039B	40	SSMA Male	SSMP Male	Straight	1.25
A4040B	40	SSMA Male	SSMP Female	Straight	1.25
A4041B	40	SSMA Female	SSMP Male	Straight	1.25
A4042B	40	SSMA Female	SSMP Female	Straight	1.25
A4043B	40	SSMA Male	2.4mm Male	Straight	1.2
A4044B	40	SSMA Male	2.4mm Female	Straight	1.2
A4045B	40	SSMA Female	2.4mm Male	Straight	1.2
A4046B	40	SSMA Female	2.4mm Female	Straight	1.2
A2704B	34	3.5mm Female	2.92mm Female	Straight	1.2
A2705B	34	3.5mm Male	2.92mm Male	Straight	1.2
A2706B	34	3.5mm Female	2.92mm Male	Straight	1.2
A2707B	34	3.5mm Male	2.92mm Female	Straight	1.2
A2708B	34	3.5mm Male	2.4mm Female	Straight	1.2
A2709B	34	3.5mm Male	2.4mm Male	Straight	1.2
A2710B	34	3.5mm Female	2.4mm Female	Straight	1.2
A2711B	34	3.5mm Female	2.4mm Male	Straight	1.2
A2712B	34	3.5mm Female	SMP Female	Straight	1.3
A2713B	34	3.5mm Female	SMP Male	Straight	1.3
A2714B	34	3.5mm Male	SMP Male	Straight	1.3
A2715B	34	3.5mm Male	SMP Female	Straight	1.3
A2716B	34	3.5mm Male	1.85mm Male	Straight	1.2
A2717B	34	3.5mm Male	1.85mm Female	Straight	1.2
A2718B	34	3.5mm Female	1.85mm Male	Straight	1.2
A2719B	34	3.5mm Female	1.85mm Female	Straight	1.2
A2720B	34	3.5mm Male	SSMA Male	Straight	1.2
A2721B	34	3.5mm Male	SSMA Female	Straight	1.2
A2722B	34	3.5mm Female	SSMA Male	Straight	1.2
A2723B	34	3.5mm Female	SSMA Female	Straight	1.2
A1813B	18	N Male	3.5mm Male	Straight	1.15
A1814B	18	N Male	3.5mm Female	Straight	1.15
A1815B	18	N Female	3.5mm Male	Straight	1.15
A1816B	18	N Female	3.5mm Female	Straight	1.15
A1817B	18	N Male	2.92mm Male	Straight	1.15
A1818B	18	N Male	2.92mm Female	Straight	1.15
A1819B	18	N Female	2.92mm Male	Straight	1.15
A1820B	18	N Female	2.92mm Female	Straight	1.15
A1821B	18	N Male	2.4mm Male	Straight	1.15
A1822B	18	N Male	2.4mm Female	Straight	1.15
A1823B	18	N Female	2.4mm Female	Straight	1.15
A1824B	18	N Female	2.4mm Male	Straight	1.15
A1805B	18	N Male	SMA Male	Straight	1.15
A1806B	18	N Male	SMA Female	Straight	1.15
A1807B	18	N Female	SMA Male	Straight	1.15
A1808B	18	N Female	SMA Female	Straight	1.15
A1809B	18	N Male	SSMA Male	Straight	1.15
A1810B	18	N Male	SSMA Female	Straight	1.15
A1811B	18	N Female	SSMA Male	Straight	1.15
A1812B	18	N Female	SSMA Female	Straight	1.15

汎用タイプ(アダプタ) Bモデル

モデル番号	周波数 (GHz)	コネクタ 1	コネクタ 2	スタイル	VSWR
A1831B	18	SMA Male	SSMA Male	Straight	1.15
A1832B	18	SMA Male	SSMA Female	Straight	1.15
A1833B	18	SMA Female	SSMA Male	Straight	1.15
A1834B	18	SMA Female	SSMA Female	Straight	1.15
A1835B	18	SMA Male	SMP Male	Straight	1.25
A1836B	18	SMA Male	SMP Female	Straight	1.25
A1837B	18	SMA Female	SMP Male	Straight	1.25
A1838B	18	SMA Female	SMP Female	Straight	1.25
A1839B	18	SMA Male	SSMP Male	Straight	1.2
A1840B	18	SMA Male	SSMP Female	Straight	1.2
A1841B	18	SMA Female	SSMP Male	Straight	1.2
A1842B	18	SMA Female	SSMP Female	Straight	1.2
A1843B	18	SMA Male	3.5mm Male	Straight	1.15
A1844B	18	SMA Male	3.5mm Female	Straight	1.15

・コストパフォーマンス・ステンレススチール製
・100% RF テスト, メーカー在庫

モデル番号	周波数 (GHz)	コネクタ 1	コネクタ 2	スタイル	VSWR
A1845B	18	SMA Female	3.5mm Male	Straight	1.15
A1846B	18	SMA Female	3.5mm Female	Straight	1.15
A1847B	18	SMA Male	2.92mm Male	Straight	1.15
A1848B	18	SMA Male	2.92mm Female	Straight	1.15
A1849B	18	SMA Female	2.92mm Male	Straight	1.15
A1850B	18	SMA Female	2.92mm Female	Straight	1.15
A1851B	18	SMA Male	2.4mm Male	Straight	1.15
A1852B	18	SMA Male	2.4mm Female	Straight	1.15
A1853B	18	SMA Female	2.4mm Male	Straight	1.15
A1854B	18	SMA Female	2.4mm Female	Straight	1.15
A1855B	18	SMA Male	1.85mm Male	Straight	1.15
A1856B	18	SMA Male	1.85mm Female	Straight	1.15
A1857B	18	SMA Female	1.85mm Male	Straight	1.15
A1858B	18	SMA Female	1.85mm Female	Straight	1.15

LOW PIM タイプ Lモデル

Low PIM DIN 7/16, N, 4.3-10, 4.1-9.5, 2.2-5, NEX10

・ Low PIM < -160dBc ・ Low VSWR ・ 取メタル耐腐食及び摩耗性加工

モデル番号	周波数 (GHz)	コネクタ 1	コネクタ 2	VSWR	PIM(dBc)
A0601L	DC-6	DIN 7/16 Female	DIN 7/16 Female	1.25	-160
A0602L	DC-6	DIN 7/16 Female	DIN 7/16 Male	1.25	-160
A0603L	DC-6	DIN 7/16 Male	DIN 7/16 Male	1.25	-160
A0604L	DC-6	N Female	N Female	1.15	-160
A0605L	DC-6	N Female	N Male	1.15	-160
A0606L	DC-6	N Male	N Male	1.15	-160
A0607L	DC-6	4.3-10 Female	4.3-10 Female	1.25	-160
A0608L	DC-6	4.3-10 Female	4.3-10 Male	1.25	-160
A0609L	DC-6	4.3-10 Male	4.3-10 Male	1.25	-160
A0608L-RA	DC-6	4.3-10 Female	4.3-10 Male	1.25	-160
A0610L	DC-6	4.1-9.5 Female	4.1-9.5 Female	1.25	-160
A0611L	DC-6	4.1-9.5 Female	4.1-9.5 Male	1.25	-160
A0612L	DC-6	4.1-9.5 Male	4.1-9.5 Male	1.25	-160
A0613L	DC-6	2.2-5 Female	2.2-5 Female	1.25	-160
A0614L	DC-6	2.2-5 Female	2.2-5 Male	1.25	-160
A0615L	DC-6	2.2-5 Male	2.2-5 Male	1.25	-160
A0616L	DC-6	NEX10 Female	NEX10 Female	1.25	-160
A0617L	DC-6	NEX10 Female	NEX10 Male	1.25	-160
A0618L	DC-6	NEX10 Male	NEX10 Male	1.25	-160
A0631L	DC-6	DIN 7/16 Female	4.3-10 Female	1.25	-160
A0632L	DC-6	DIN 7/16 Female	4.3-10 Male	1.25	-160
A0633L	DC-6	DIN 7/16 Male	4.3-10 Female	1.25	-160
A0634L	DC-6	DIN 7/16 Male	4.3-10 Male	1.25	-160
A0635L	DC-6	DIN 7/16 Female	4.1-9.5 Female	1.25	-160
A0636L	DC-6	DIN 7/16 Female	4.1-9.5 Male	1.25	-160
A0637L	DC-6	DIN 7/16 Male	4.1-9.5 Female	1.25	-160
A0638L	DC-6	DIN 7/16 Male	4.1-9.5 Male	1.25	-160
A0639L	DC-6	DIN 7/16 Female	N Female	1.25	-160
A0640L	DC-6	DIN 7/16 Female	N Male	1.25	-160
A0641L	DC-6	DIN 7/16 Male	N Female	1.25	-160
A0642L	DC-6	DIN 7/16 Male	N Male	1.25	-160
A0643L	DC-6	DIN 7/16 Female	NEX10 Female	1.25	-160
A0644L	DC-6	DIN 7/16 Female	NEX10 Male	1.25	-160
A0645L	DC-6	DIN 7/16 Male	NEX10 Female	1.25	-160
A0646L	DC-6	DIN 7/16 Male	NEX10 Male	1.25	-160
A0647L	DC-6	DIN 7/16 Female	SMA Female	1.25	-160
A0648L	DC-6	DIN 7/16 Female	SMA Male	1.25	-160
A0649L	DC-6	DIN 7/16 Male	SMA Female	1.25	-160
A0650L	DC-6	DIN 7/16 Male	SMA Male	1.25	-160
A0651L	DC-6	DIN 7/16 Female	2.2-5 Female	1.25	-160
A0652L	DC-6	DIN 7/16 Female	2.2-5 Male	1.25	-160
A0653L	DC-6	DIN 7/16 Male	2.2-5 Female	1.25	-160

モデル番号	周波数 (GHz)	コネクタ 1	コネクタ 2	VSWR	PIM(dBc)
A0654L	DC-6	DIN 7/16 Male	2.2-5 Male	1.25	-160
A0655L	DC-6	4.3-10 Female	N Female	1.25	-160
A0656L	DC-6	4.3-10 Female	N Male	1.25	-160
A0657L	DC-6	4.3-10 Male	N Female	1.25	-160
A0658L	DC-6	4.3-10 Male	N Male	1.25	-160
A0659L	DC-6	4.1-9.5 Female	N Female	1.25	-160
A0660L	DC-6	4.1-9.5 Female	N Male	1.25	-160
A0661L	DC-6	4.1-9.5 Male	N Female	1.25	-160
A0662L	DC-6	4.1-9.5 Male	N Male	1.25	-160
A0663L	DC-6	N Female	NEX10 Female	1.25	-160
A0664L	DC-6	N Female	NEX10 Male	1.25	-160
A0665L	DC-6	N Male	NEX10 Female	1.25	-160
A0666L	DC-6	N Male	NEX10 Male	1.25	-160
A0667L	DC-6	N Female	SMA Female	1.25	-155
A0668L	DC-6	N Female	SMA Male	1.25	-155
A0669L	DC-6	N Male	SMA Female	1.25	-155
A0670L	DC-6	N Male	SMA Male	1.25	-155
A0671L	DC-6	N Female	QMA Female	1.25	-155
A0672L	DC-6	N Female	QMA Male	1.25	-155
A0673L	DC-6	N Male	QMA Female	1.25	-155
A0674L	DC-6	N Male	QMA Male	1.25	-155
A0671L-F	DC-6	N Female	QMA Female	1.25	-155
A0675L	DC-6	N Female	2.2-5 Female	1.25	-160
A0676L	DC-6	N Female	2.2-5 Male	1.25	-160
A0677L	DC-6	N Male	2.2-5 Female	1.25	-160
A0678L	DC-6	N Male	2.2-5 Male	1.25	-160
A0679L	DC-6	NEX10 Female	SMA Female	1.25	-155
A0680L	DC-6	NEX10 Female	SMA Male	1.25	-155
A0681L	DC-6	NEX10 Male	SMA Female	1.25	-155
A0682L	DC-6	NEX10 Male	SMA Male	1.25	-155
A0683L	DC-6	QN Female	N Female	1.2	-155
A0684L	DC-6	QN Female	N Male	1.2	-155
A0685L	DC-6	QN Male	N Female	1.2	-155
A0686L	DC-6	QN Male	N Male	1.2	-155
A0687L	DC-6	QN Female	TNC Female	1.2	-155
A0688L	DC-6	QN Female	TNC Male	1.2	-155
A0689L	DC-6	QN Male	TNC Female	1.2	-155
A0690L	DC-6	QN Male	TNC Male	1.2	-155
A0691L	DC-6	4310 Female	NEX10 Female	1.25	-160
A0692L	DC-6	4310 Female	NEX10 Male	1.25	-160
A0693L	DC-6	4310 Male	NEX10 Female	1.25	-160
A0694L	DC-6	4310 Male	NEX10 Male	1.25	-160